

Bank Street Concept Design

Concept Design features:

- › Continuous, kerbless, natural stone and concrete surface treatment
 - › Vehicle path of travel diverts at Woodsons Lane
 - › 3m wide activity zones to north-east and south-west
 - › 3m wide shared carriageway
- › 1400mm wide textured paving strip delineating shoreline of 2.0m clear path of travel parallel to building edges
 - › 13 street trees
 - › 4 parking / loading spaces
 - › Continuous footpaths at Hindley St. and North Tce.
- › Designated zones for outdoor dining
 - › Smart pole lighting
 - › Robust bespoke street furniture
 - › Public art and integrated artistic elements throughout link

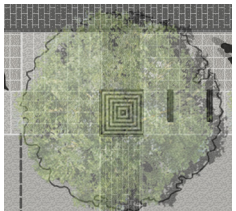
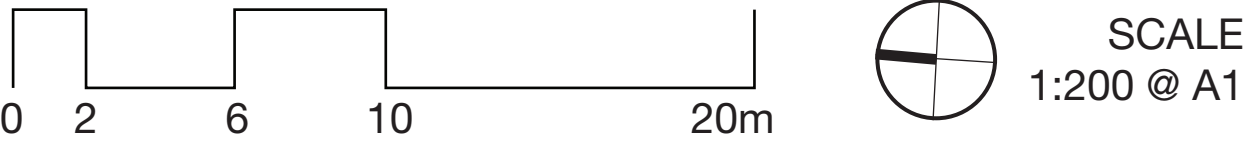

In-ground tree

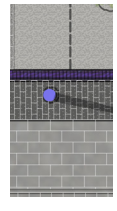

Smart light pole

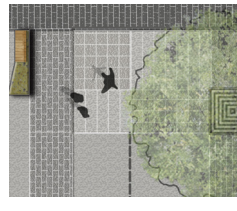

Seating areas

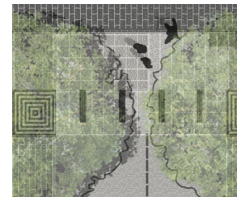

Bike Racks

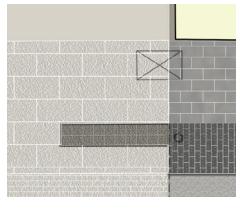

Tactile ground surface indicators

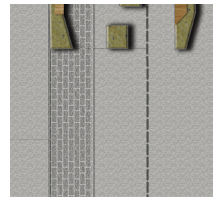

Stone paving bands

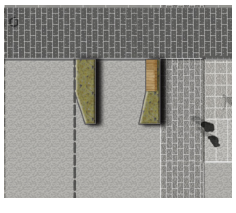

Granite plinth seating

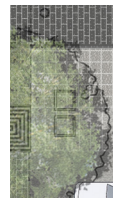

Rubbish bins

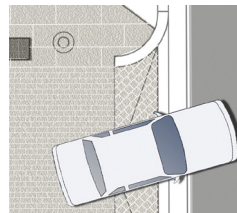

Vehicular ramp

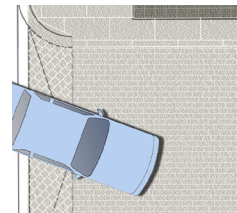

Raised paved threshold (continuous footpath)

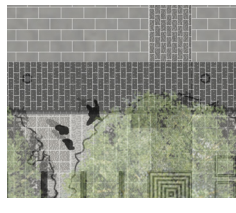

Textured delineating paving strip

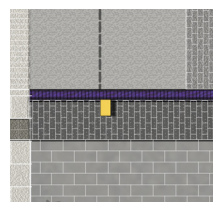

Shared zone/ speed limit signage totem

DRAFT